

RYNO[®] MODULAR → LINKING BRACKET

PART1

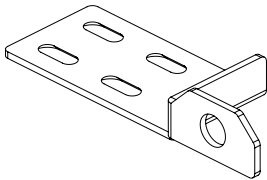

BRACKET A

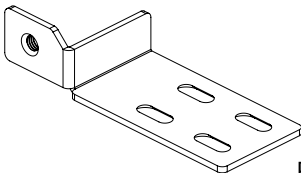

BRACKET B

REQUIRED
ITEMS

- 2 x Bracket A
- 2 x Bracket B
- 16 x M6 Threaded Hex Drive Insert Fixing
- 16 x M6 x 20 Countersunk Security Bolt
- Power Drill
- H6 Hex Screwdriver Bit
- Hex Magnetic Bit Holder
- Hex Magnetic Bit Extention (300mm+)
- TX30 Magnetic Screwdriver Bit
- TX45 magnetic Screwdriver bit
- 3mm Dowel Drill Bit
- 7.5mm Dowel Drill Bit
- Felt-Tip Pen & Ruler



+44 (0)1622 237830

sales@pineapplecontracts.com

Pineapple

RYNO[®] MODULAR → LINKING BRACKET

PART1

01

Rotate **both** Ryno Modular Units 180 degrees, so that both pieces are now facing bottom-side up (see next step).

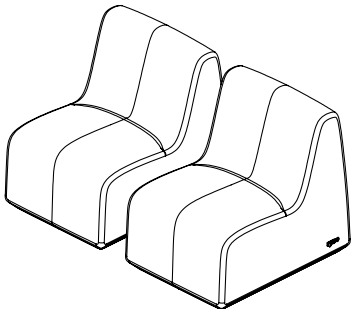

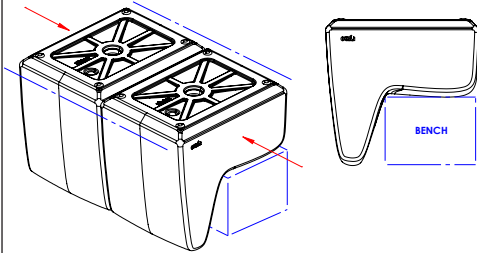

Rest the Ryno Modular units on a flat bench to keep both pieces level. Push both units together, ensuring that the front and back are inline.

Note: Place a dust sheet on top of the bench to ensure that the Ryno Modular sections do not get damaged.

02

2A

Align the edges of **Bracket B** with the front and side edge of the recess on the Left Ryno Modular section, using a **felt-tip pen**, mark the position of the bracket's front edge and centres of the slots.

Remove the bracket, using a **power drill** with a **3mm drill bit**, drill the pilot holes in the 4x marked points.

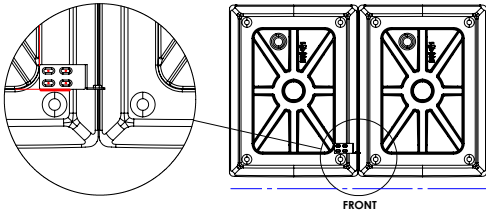
2A: JOINING STRAIGHT SECTIONS ONLY

2B

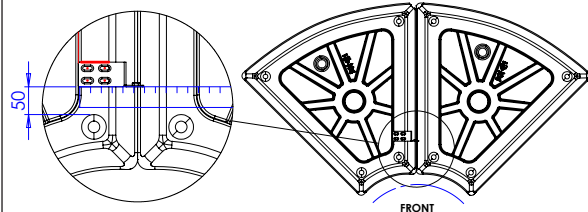
2B: JOINING SECTIONS WITH CURVES

Align the left edge of the **Bracket B** with the side edge of the recess on the left Ryno Modular section. Ensuring that the front is straight, position **Bracket B** 50mm from the back of the foot. Using a **felt-tip pen**, mark the position of the bracket's rear edge and the centre of the slots.

Remove the bracket, using a **power drill** with a **3mm drill bit**, drill the pilot holes in the 4x marked points.

RYNO[®] MODULAR → LINKING BRACKET

PART1

3A: JOINING STRAIGHT SECTIONS ONLY

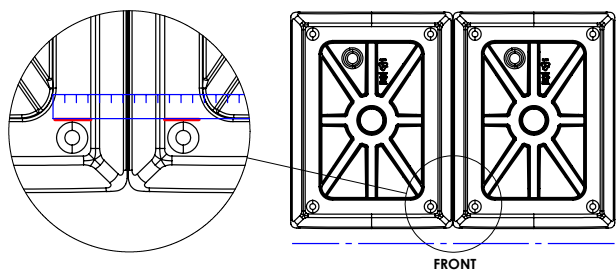

3B: JOINING SECTIONS WITH CURVES

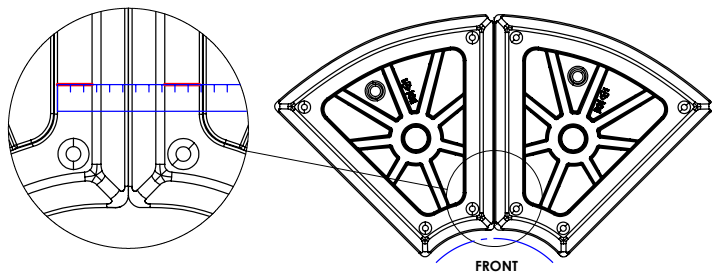

3A

Ensuring that the 2 Ryno Modular sections are inline, use a **ruler** to mark out a straight line on the Right Ryno Modular section, so that the marked-out lines on both adjoining units are colinear.

3B

4A

On the Right Ryno Modular section, take **Bracket A** and align the edges with the front and side edges of the recess as well as the marked-out line made in the previous step.

Using a **felt-tip pen**, mark the centres of the slots.

Remove the bracket, using a **power drill** with a **3mm drill bit**, drill the holes in the 4x marked points. Remove the 3mm drill bit from the power drill and attach the **7.5mm drill bit**, using the pilot holes as a template, drill 7.5mm through holes.

4A: JOINING STRAIGHT SECTIONS ONLY

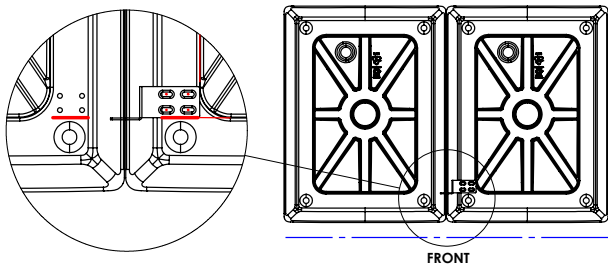

+44 (0)1622 237830



sales@pineapplecontracts.com

Pineapple

RYNO[®] MODULAR → LINKING BRACKET

PART1

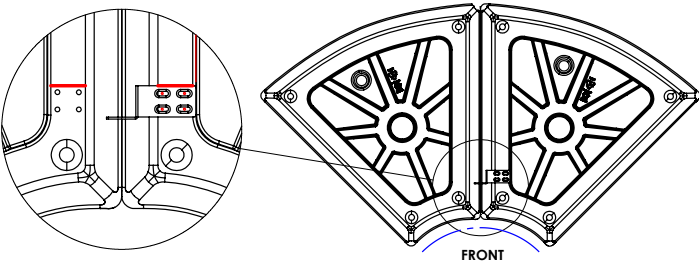
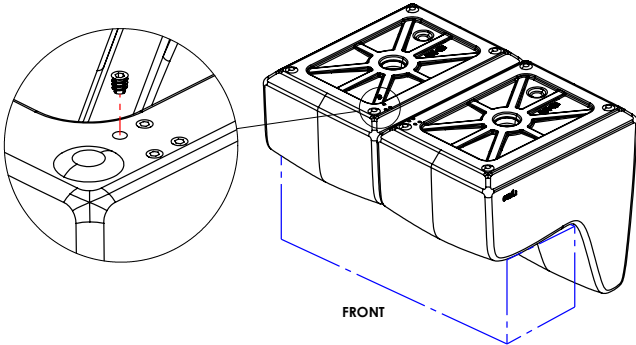
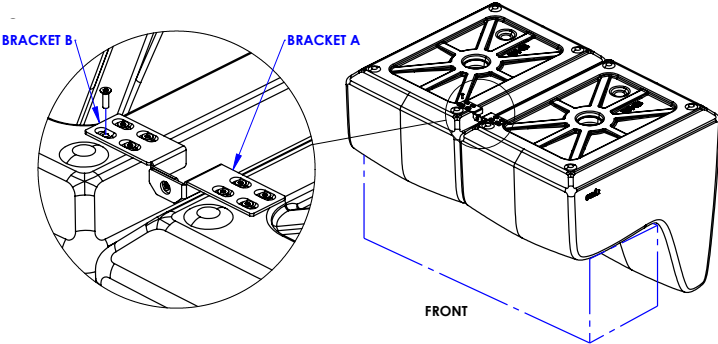
4B	<p>On the Right Ryno Modular section, take Bracket A and align it with the side edge of the recess as well as the marked-out line made in the previous step.</p> <p>Using a felt-tip pen, mark the centre of the slots.</p> <p>Remove the bracket, using a power drill with a 3mm drill bit, drill the holes in the 4x marked points. Remove the 3mm drill bit from the power drill and attach the 7.5mm drill bit, using the pilot holes as a template, drill 7.5mm through holes.</p>	<div>4B: <u>JOINING SECTIONS WITH CURVES</u></div> <div></div>
05	<p>Using a power drill with a H6 Hex Screwdriver attachment, drive the M6 inserts into the through-holes in both the Left and Right Ryno Modular sections.</p>	<div></div>
<div></div>	<p>Using a power drill with a T30 Torx Screwdriver attachment, screw Bracket A and Bracket B to the Left and Right Ryno Modular sections respectively using M6 x 20 Countersunk security bolts.</p>	06

RYNO[®] MODULAR → LINKING BRACKET PART 1

07

Using a **power drill** with a **T45 screwdriver bit**, fix the **M10 x 20 security bolt** and **M10 washer** into front brackets so that they are securely connected, ensure that the screws are not over tightened.

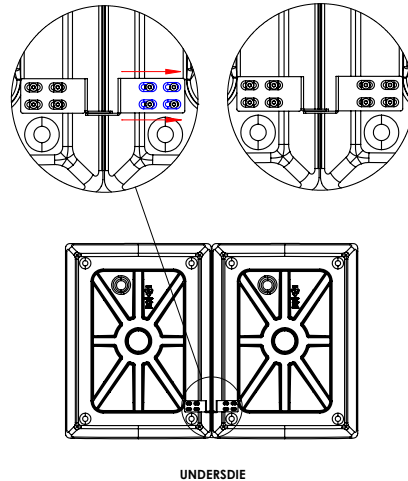
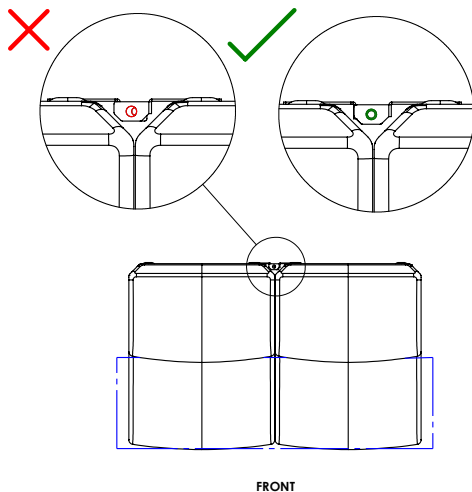
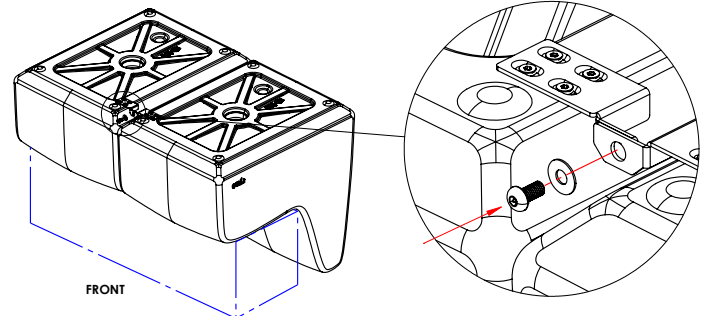

08

Note: If the securing holes on the brackets are misaligned, unscrew the **M6 security bolts** that are holding the misaligned brackets in place until the brackets become adjustable.

Adjust the brackets to the appropriate position using the oval fixing slots. Once the bracket is in the correct position, re-secure the brackets using the **M6 security bolts**, ensuring they are not over tightened.



+44 (0)1622 237830
sales@pineapplecontracts.com

Pineapple

RYNO[®] MODULAR → LINKING BRACKET PART 1

09

Repeat steps 2-8 to install the rear set of brackets to the Ryno Modular sections.

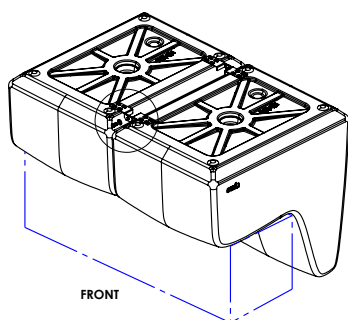
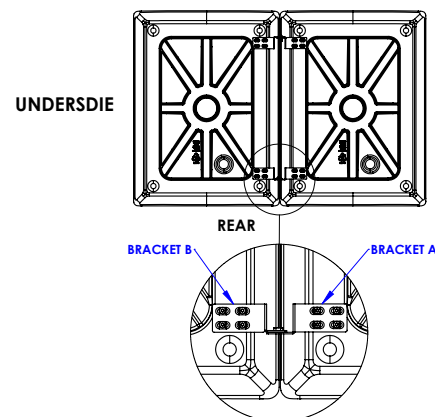
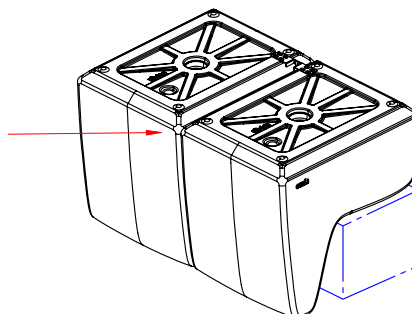

FRONT

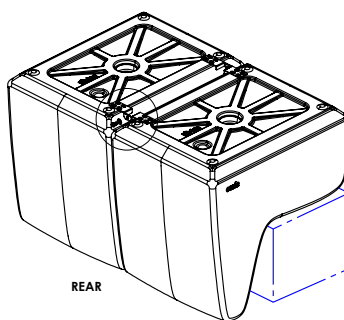
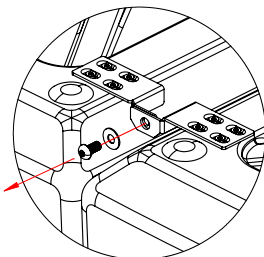

REAR

10

Using a power drill with a **T45 screwdriver bit**, unfix the **M10 x 20 security bolts** and **M10 washer** into front and rear set of brackets so that the Ryno Modular sections are disconnected.

Note: If you are connecting multiple Ryno Modular sections, repeat steps 1-10 before proceeding to **Part 2** of the instructions.



+44 (0)1622 237830

sales@pineapplecontracts.com

Pineapple

DISCLAIMER

	<div><div>→</div><div>Ensure the proper and adequate hardware is used to secure furniture</div></div> <div><div>→</div><div>Ensure fixings are appropriate for the anchoring material</div></div> <div><div>→</div><div>Use fixings of an appropriate strength and consider using security fixings in challenging environments</div></div> <div><div>→</div><div>Consider using high strength thread-locker on fixings in challenging environments</div></div> <div><div>→</div><div>Ensure all gaps are sealed with the appropriate anti-pick mastic after product installation if necessary</div></div> <div><div>→</div><div>Please read all instructions carefully to ensure proper installation. Failure to read and follow instructions may result inadequate product installation and void of warranty</div></div> <div><div>→</div><div>Pineapple shall not be held liable for any consequences caused by the improper installation of products to the installer or the end user</div></div>