

OHIO RANGE

→ INSTALLATION GUIDE

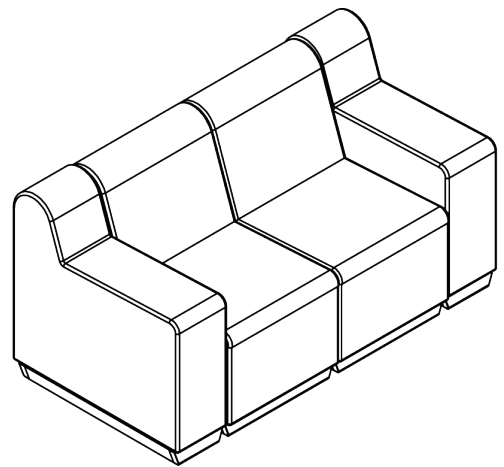
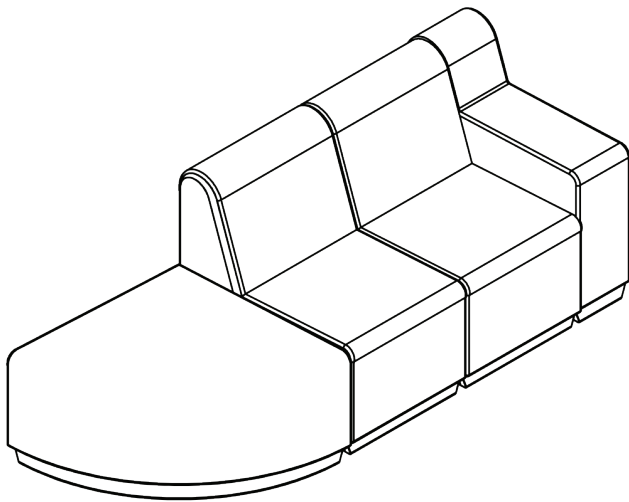
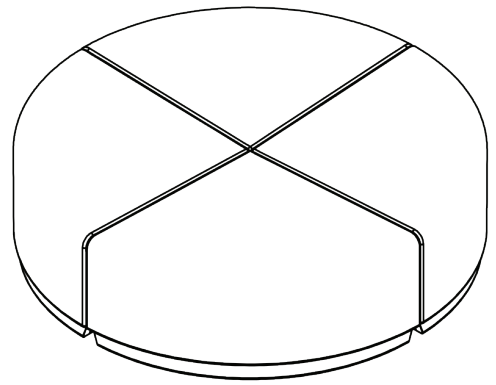

WARNING: Read this document prior to installation.

- Collect the required equipment prior to installation.
- Installation and commissioning should only be carried out by authorised and qualified personnel.

Version 2.6

Release date: 19/11/2025



+44 (0)1622 237830

sales@pineapplecontracts.com

Pineapple

KIT OF PARTS

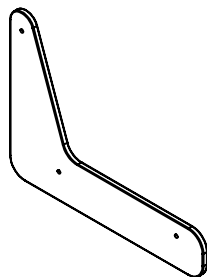

→ Large fixing panel

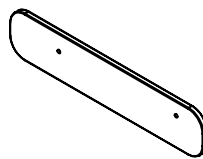

→ Small fixing panel

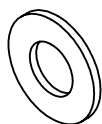

→ M8 Washer

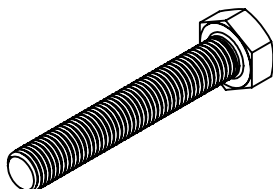

→ M8 x 11mm Bolt

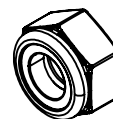

→ M8 x 11mm Nylon
locking nut

REQUIRED EQUIPMENT

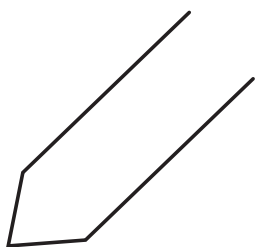

→ Sharp object
to pierce

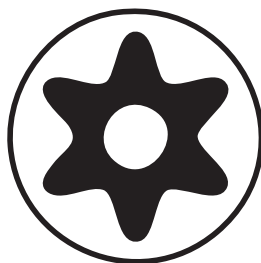

→ TX25 tamperproof
drill bit



→ 10mm Wrench

→ ATTACHING BACKED OHIO COMPONENTS

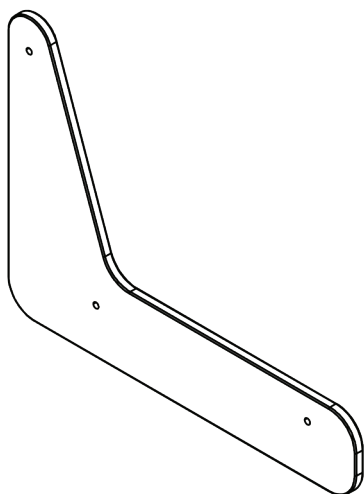
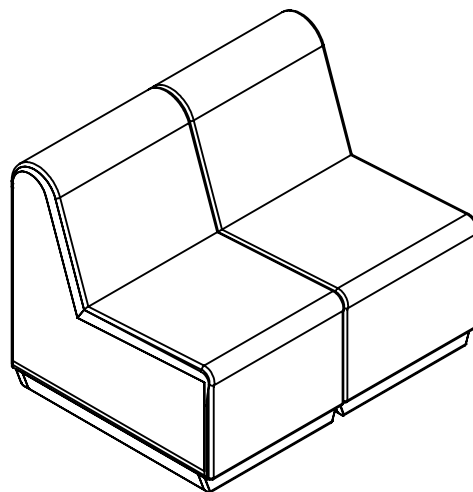
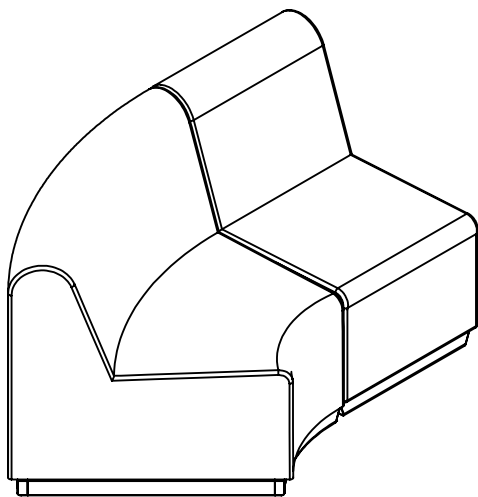

Large fixing panel:

- Used for the joining of any two Ohio sections which both have backs.
- Follow instructions, attaching at five fixing points shown.

→ ATTACHING NON-BACKED OHIO COMPONENTS

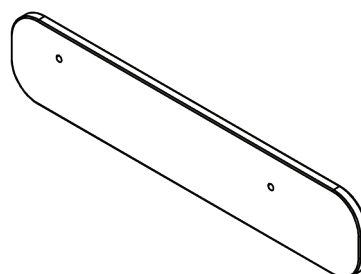
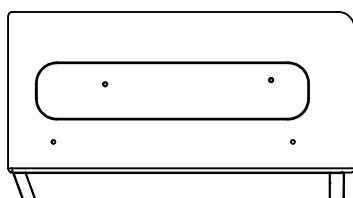
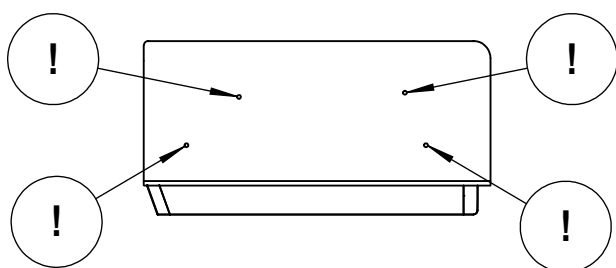
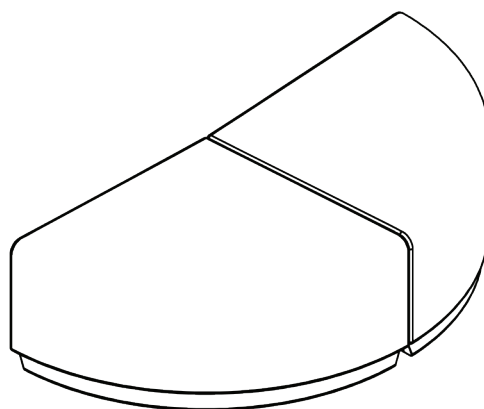
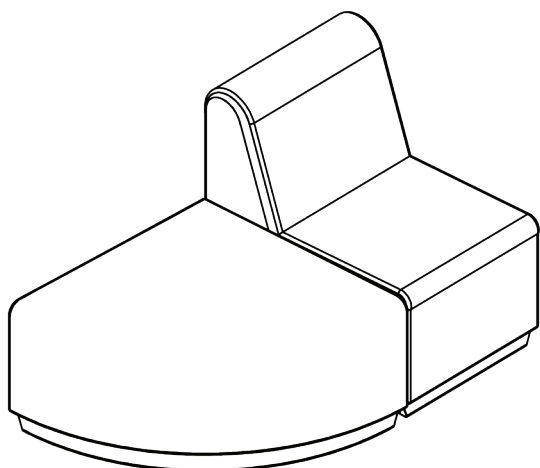

Small fixing panel:

- Used for the joining of any two Ohio sections involving a non-backed section.
- Follow installation guide, adjusting to only attach at the four fixing points shown in diagram (left).

→ ATTACHING OHIO SIDEARMS

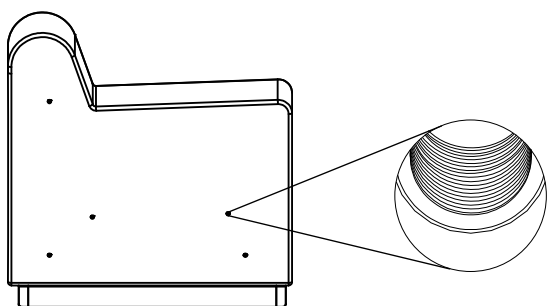
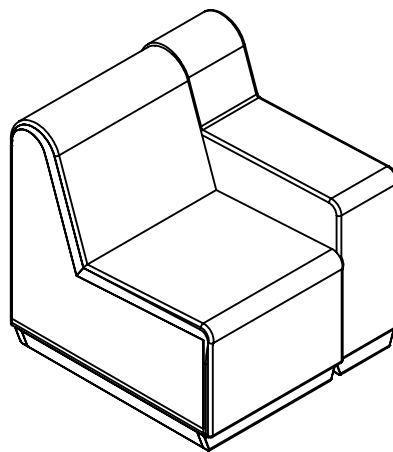
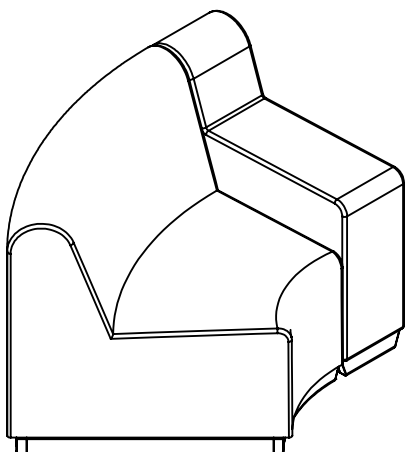

Pre-installed threads:

- Ohio sidearm sections come with a pre-installed threaded insert at the attachment points.
- Connect arm to Ohio sections using supplied bolt and washer, screwing into pre-installed threaded insert in the arm.

OHIO RANGE → INSTALLATION GUIDE

01

→ Overturn both Ohio sections, to access base panel.

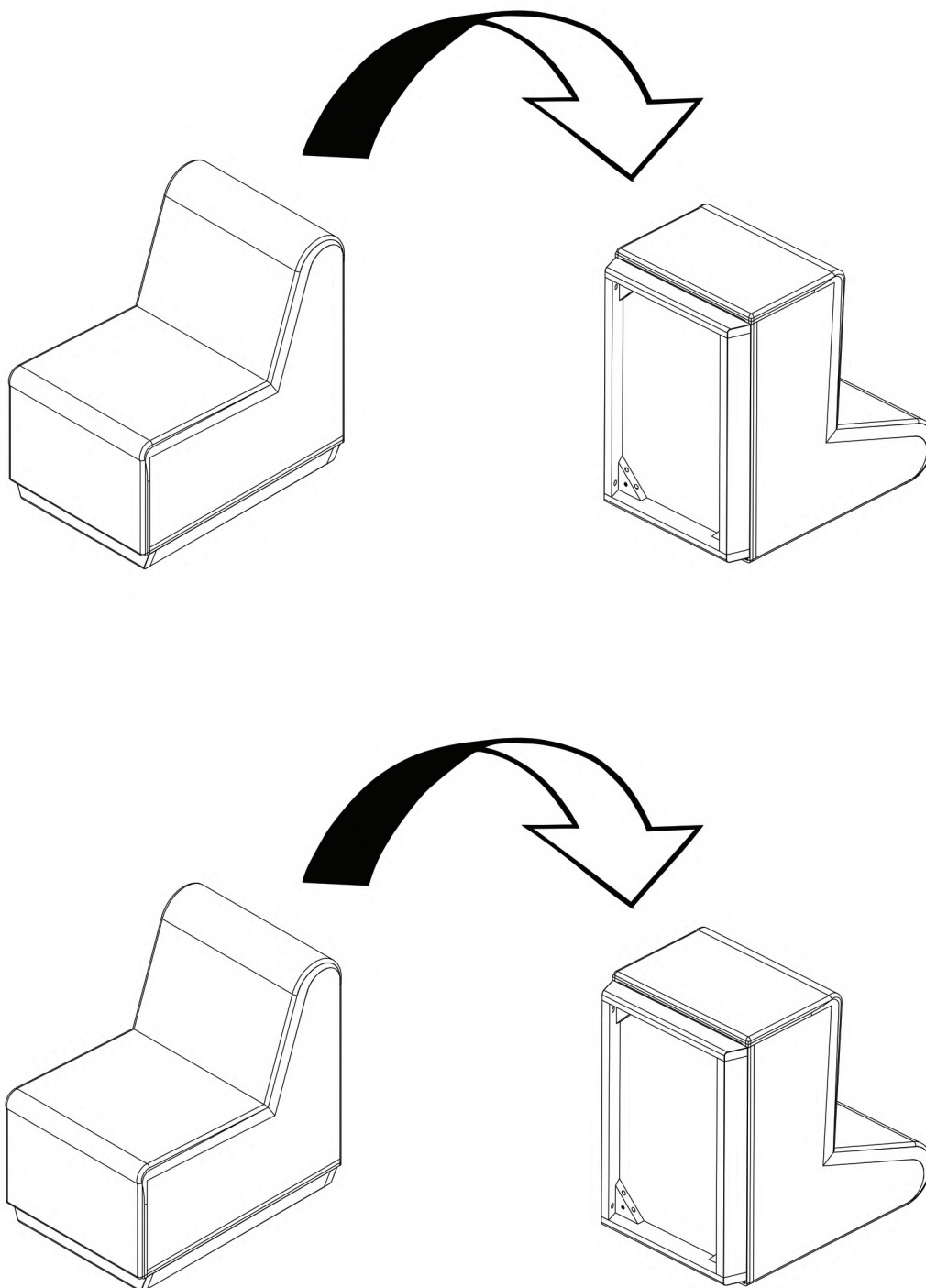

OHIO RANGE → INSTALLATION GUIDE

02

→ Remove the base panels of both Ohio sections using the Torx bit.

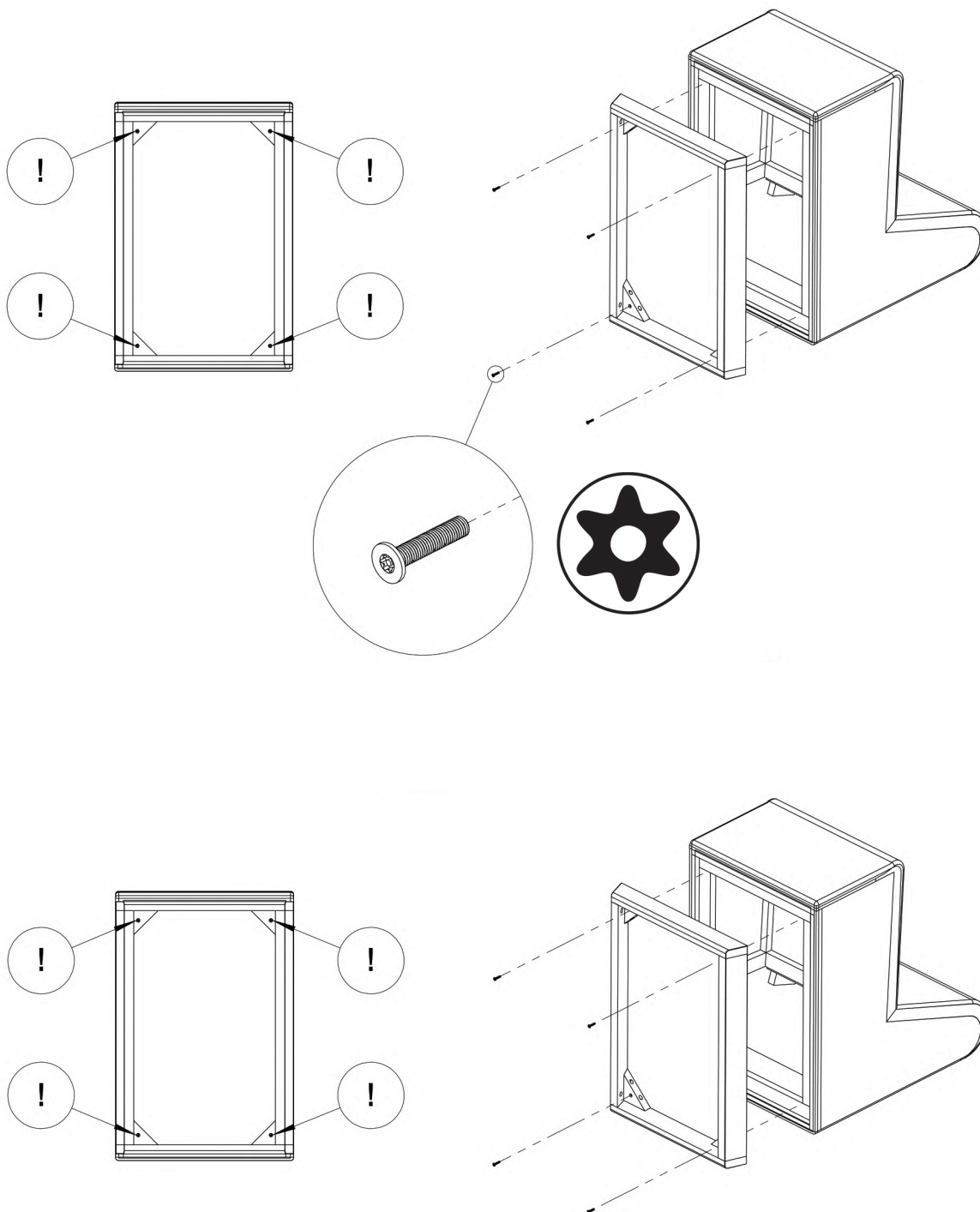

03

→ Locate the five attachment points on the inside panel of each Ohio section. These can be felt from the outside through the upholstery, or identified from the inside panel.

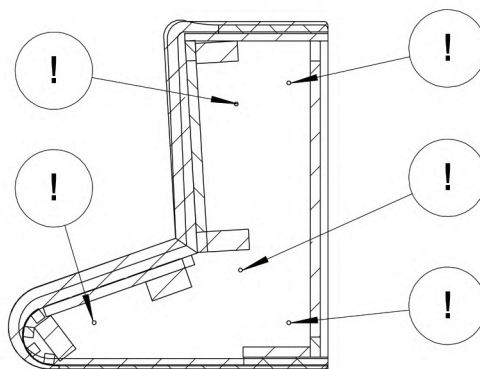
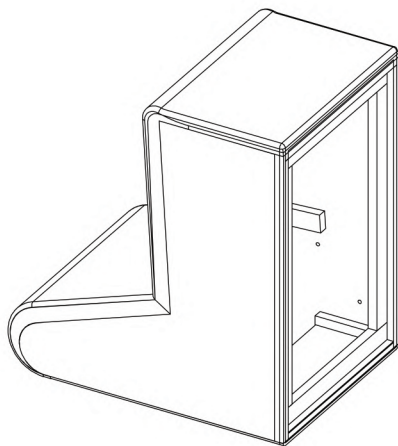
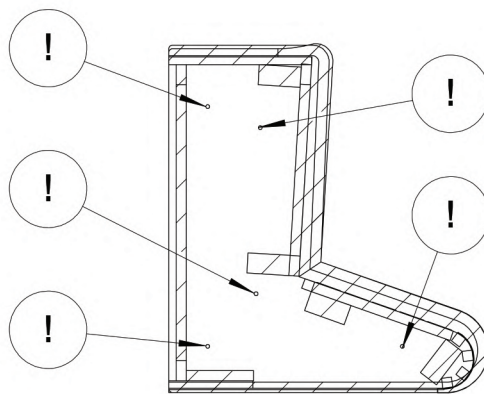
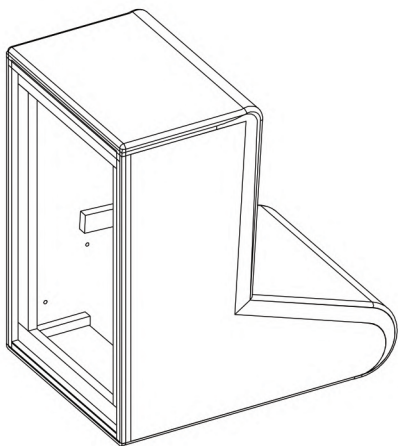

OHIO RANGE → INSTALLATION GUIDE

04

→ Using a sharp object, pierce the external side of the Ohio sections in line with identified attachment points.

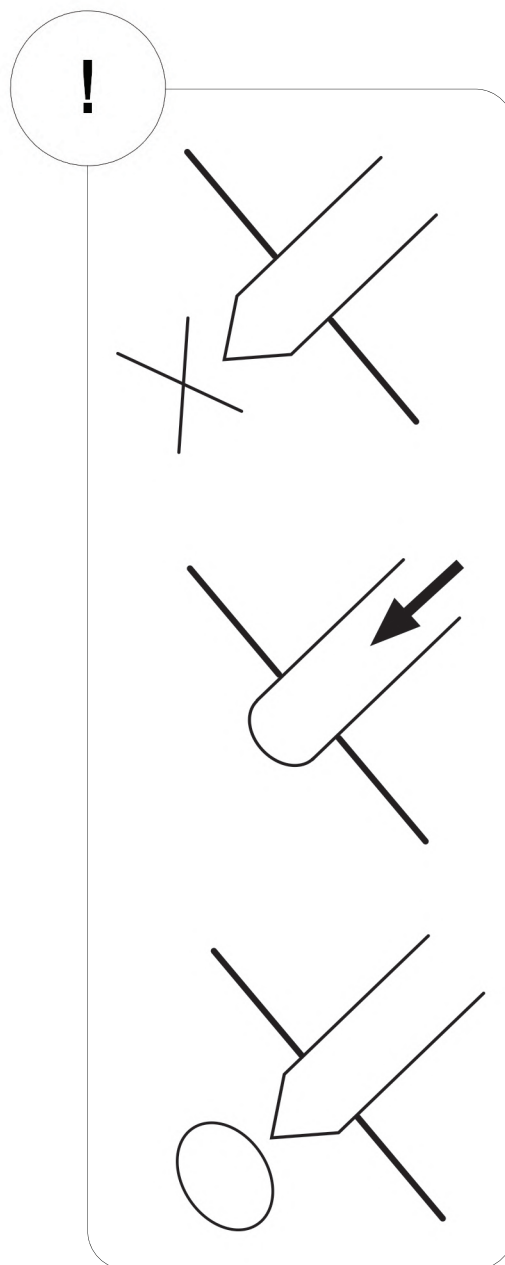
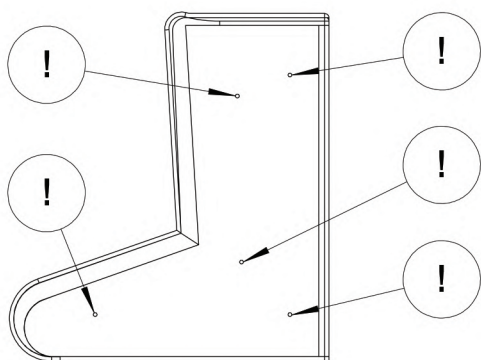
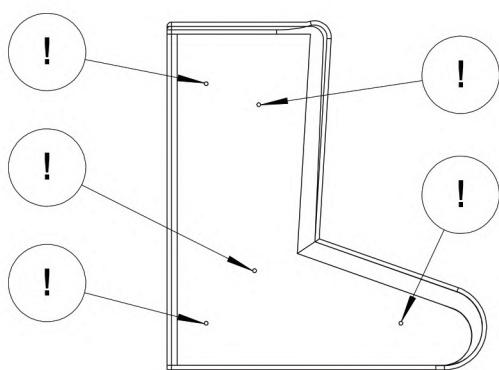

05

→ Attach the fixing panel to the first Ohio section as shown, using the supplied bolt and washer.

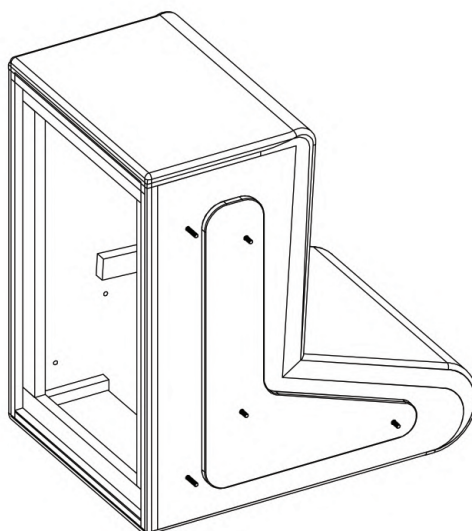
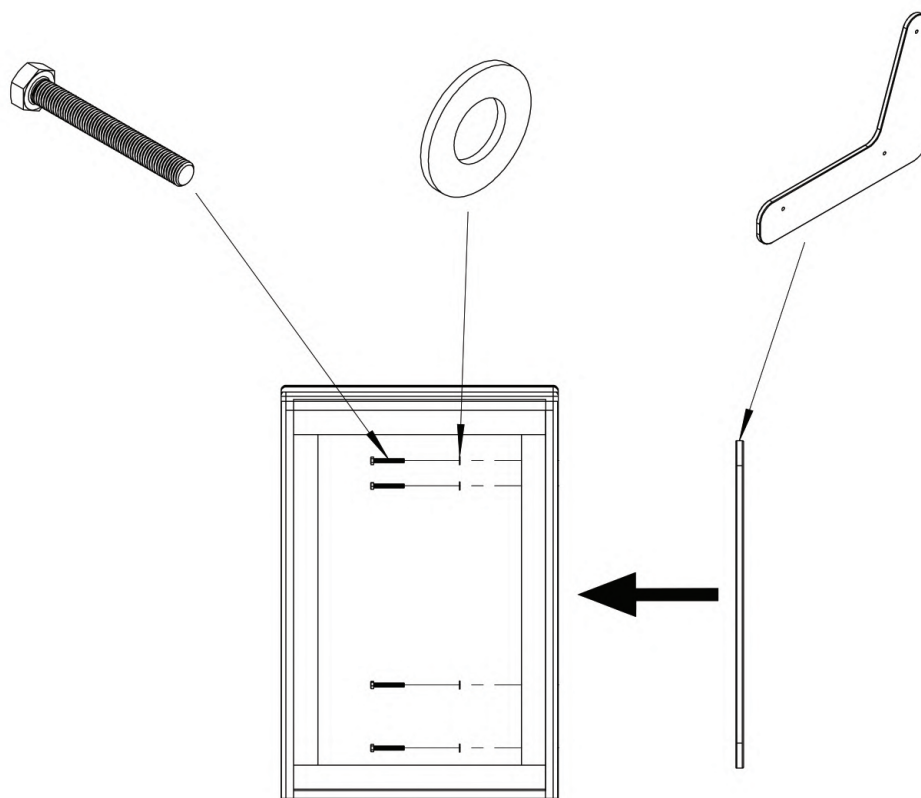

OHIO RANGE → INSTALLATION GUIDE

06

→ Bring the two Ohio sections together, aligning the attachment points. Then, using a wrench, fasten the second Ohio section to the first using the supplied nuts and washer.

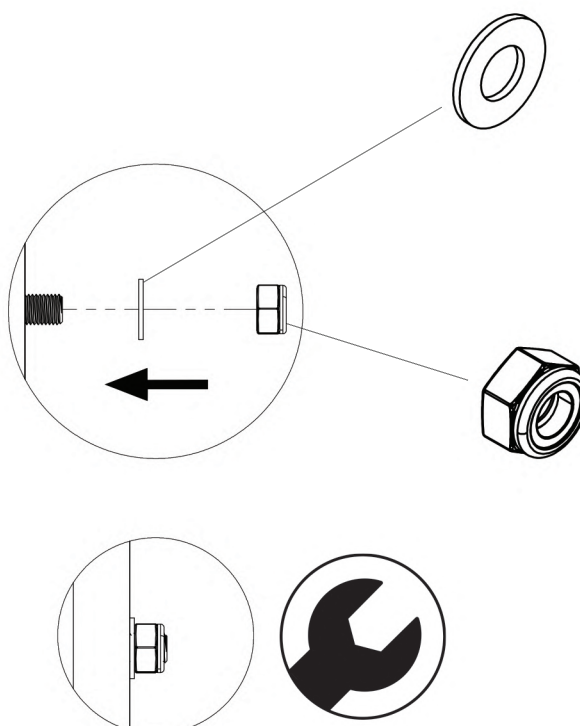
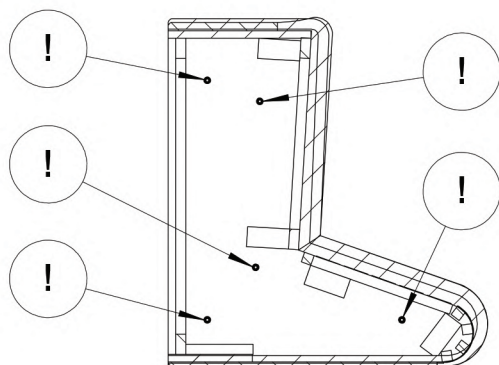
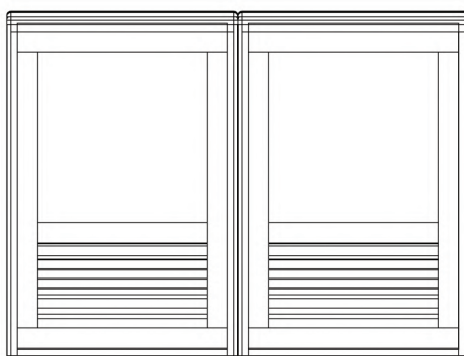
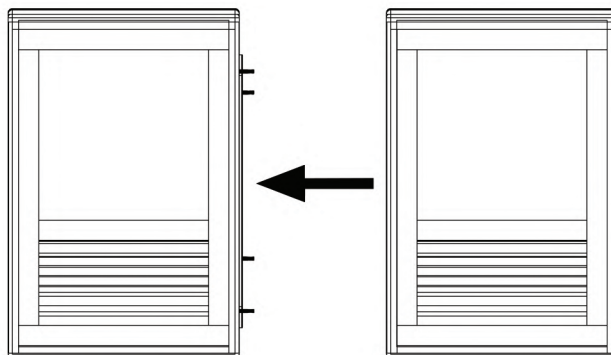

07

→ Re-attach the base panels using the Torx screws. Overturn the joined Ohio sections upright.

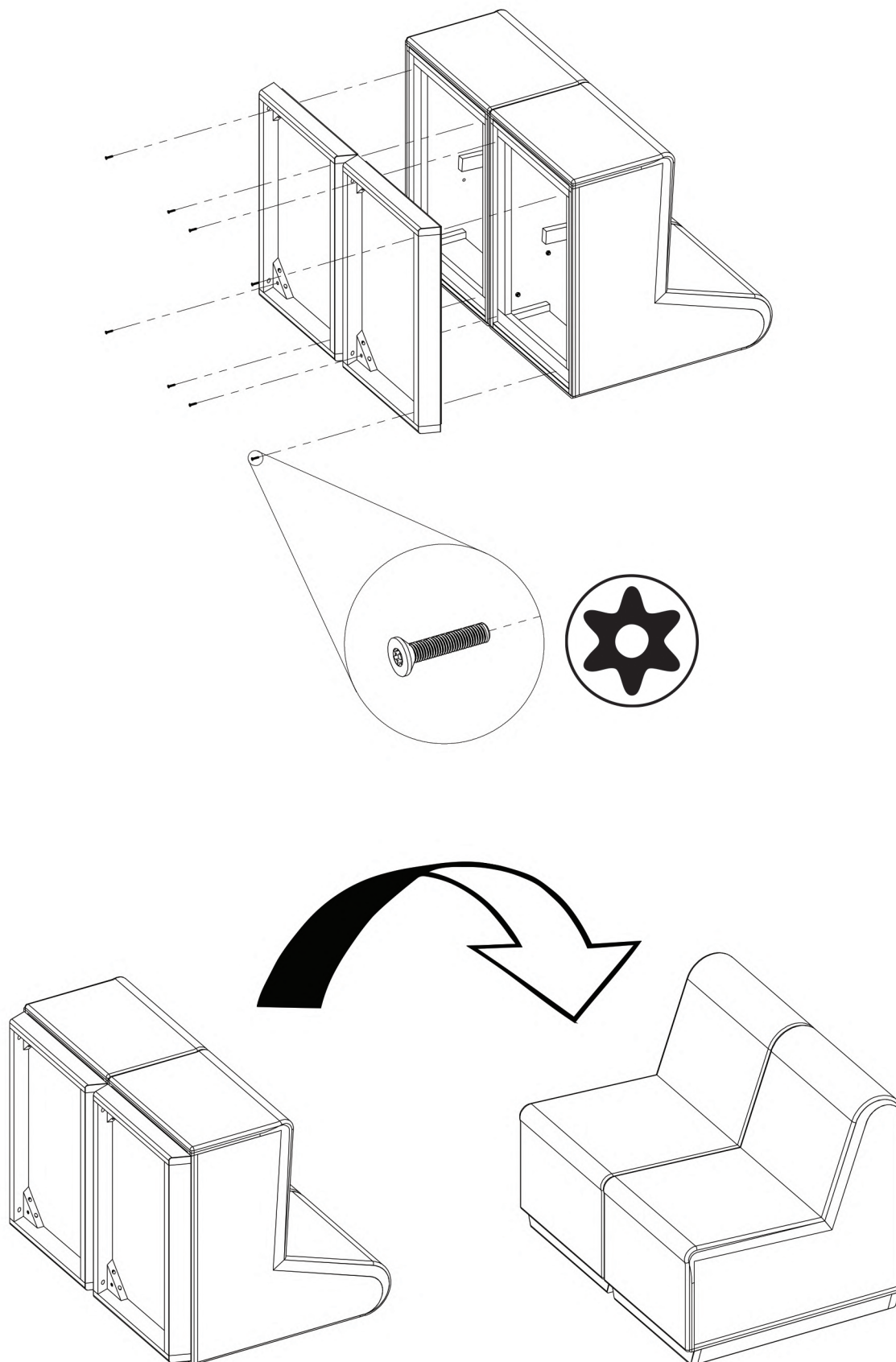

→ CONSTRUCTION LIMITATIONS

- Multiple Ohio sections can be linked to create the desired layout. Please note that there are limitations to the size and design of layouts. Linking Ohio sections requires access to the base, and each section must be overturned at both the start and end of the linking process.

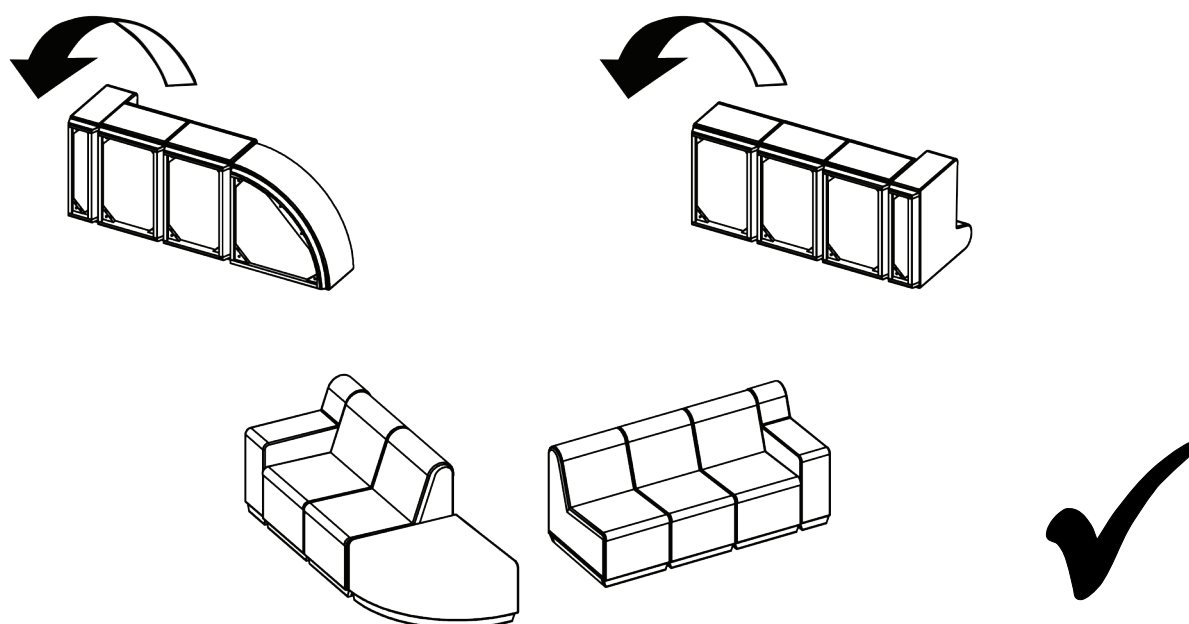
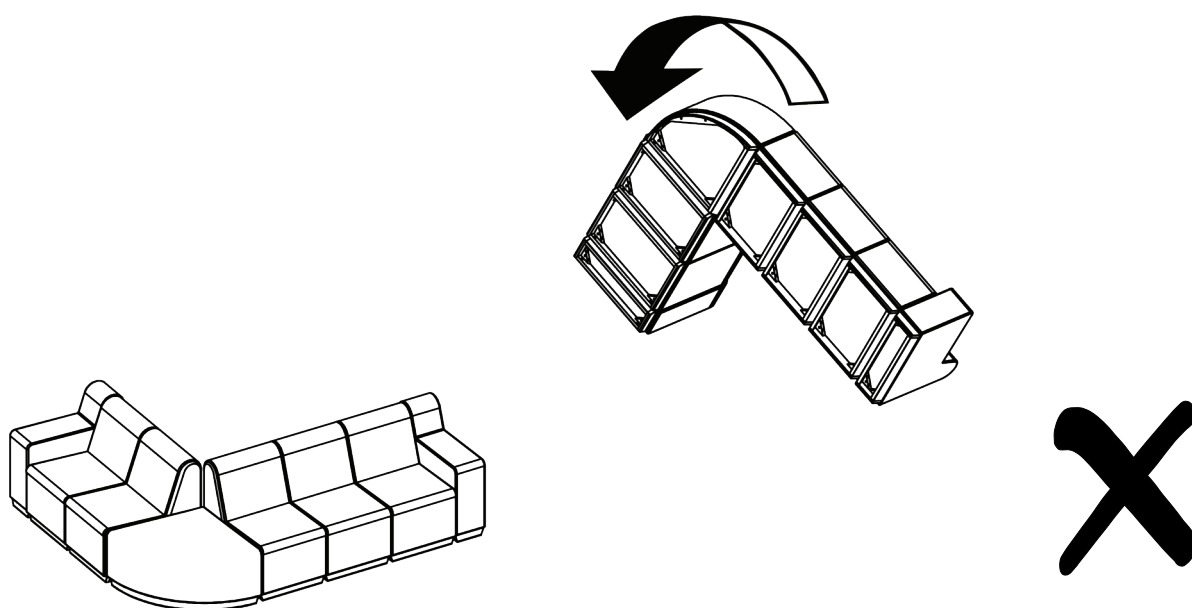

→ DISCLAIMER

- Ensure the proper and adequate hardware is used to secure furniture
- Ensure fixings are appropriate for the anchoring material
- Use fixings of an appropriate strength and consider using security fixings in challenging environments
- Consider using high strength thread-locker on fixings in challenging environments
- Ensure all gaps are sealed with the appropriate anti-pick mastic after product installation if necessary
- Please read all instructions carefully to ensure proper installation. Failure to read and follow instructions may result in inadequate product installation and void of warranty
- Pineapple shall not be held liable for any consequences caused by the improper installation of products to the installer or the end user